

# NEWSLETTER

Current Attendance  
97.5%

<http://barnes-farm-junior.eschools.co.uk>

No 36 June 30th 2016



## Stars of the Week Hall of Fame



Friday 24th June 2016

6P Hani Abbas  
6C Adam Thurgood  
6S Arianna Visnakova  
5CH Jack Sykes  
5S Katie Copping  
5C Finley Woods  
4P Chloe Staines  
4T Allanah Bushnell  
4CK Jack Maton  
3RS Harry Edwards  
3S Charlie Chandler  
3V Charlie Carr  
Mid-day Star : Thomas Edwards

## Summer Fete Dress Down Day 1—Friday 1st July 2016

Tomorrow is the first of our two non-uniform days in advance of our popular Summer Fete on 15th July. In return for the privilege of your child choosing what they want to wear to school, we ask that you donate one or more of the following items to the school office:

- \* Bottles of Wines/Spirits (for the wheelbarrow raffle)
- \* Prizes of toiletries
- \* Unwanted new gifts for the Tombola
- \* Fill a Jar (sweets/small gifts etc.)
- \* Good quality teddies
- \* Used toys/books for the teddy tombola and toy stall.
- \* Cakes (please bring on the day)

Please note, Y5 are visiting Great Baddow High School on a secondary transfer visit and need to be in school uniform. The second 'dress-down' day is on Friday 8th July and has the same requirements.

## Sports Day Monday 11th July (Reserve day Weds 13th July)

The children are asked to wear the colours of their 'house' for Sports Day. Parents are invited to both parts of the day. We run competitive races in the morning, beginning at 9:15am. The afternoon begins at 1:30pm with a carousel of activities. Please ensure your child brings a hat and wears sun-cream if needed.



Class Photographs will be taken on Tuesday 5th July. They will then be available to order for the end of term.

There has been a report of threatening behaviour from some youths at the park near to Sheppard Drive. Please take care when playing there.

## MUGA gets Green Light for Summer build!

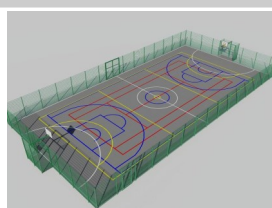

### Fundraising Goals

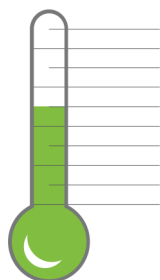

Thanks to all the donations this year towards our MUGA project, we have scheduled the multi-use games area to be built during the summer holidays. We have currently raised £6,000 which is fantastic. Our target for donations was £10,000 so we ask all of you to support our Summer fete this year as all money raised will go towards this project.

From Monday, all Pokemon trading cards (or similar games/tins/books) should not be brought into school.

### Other Key dates

<b>Fri 1st July</b>	Dress-Down Day 1
<b>Tues 5th July</b>	Class Photographs
<b>Thu 7th July</b>	5:30-7:30pm Display Evening for both schools
<b>Fri 8th July</b>	Dress Down Day 2
<b>Mon 11th July</b>	Sports Day
<b>Fri 15th July</b>	Summer Fete 3:30pm-5:30pm
<b>Tues 19th July</b>	Y6 Performance 9:15am + 7pm
<b>Weds 20th July</b>	Y6 Performance 7pm
<b>Fri 22nd July</b>	End of Summer Term
<b>Thurs 1st Sept</b>	Back to school!

